



LED COMMERCIAL DOWNLIGHT

CDL7R series

- ▶ **DESIGN** - LED COMMERCIAL DOWNLIGHT comes with a durable aluminum housing resistant to rust and impact, anti-glare PC lens, spring-loaded clips and 1.6 ft cord in metal hose. It is designed to operate on 120-277V circuits with a 0-10V dimmable driver.
- ▶ **VARIETY** - The fixture is available in 6-inch, 8-inch, and 10-inch size.
- ▶ **COLOR AND POWER SELECTABLE** - You can choose either a 2700K soft white, 3000K warm white, 3500K neutral white, 4000K cool white, or 5000K daylight color temperature, and change the power with a simple switch.
- ▶ **CRI90+** - Rating provides rich and natural colors and keeps your space looking and feeling vibrant. True bright colors also improve your mood and general health.
- ▶ **INSTALLATION** - This fixture is IC rated so there is no can or any other housing required. It is also Wet Locations rated, making it perfect for any spaces with humidity requirements. Perfect for retail, hospitality, or any other commercial space with a high ceiling.
- ▶ **ADVANTAGES** - With a lifespan of 50,000 hours, these fixtures are made to last decades under normal operation! ASD provides a 5-year limited warranty along with UL and Energy Star certifications to guarantee top quality products and safety!
- ▶ **OPTIONS:**
- ▶ **MODELS WITH BATTERY BACK-UP** - The built-in battery back-up provides 90 minutes of power in case of emergency.



PRODUCT PRESENTATION:

Model	Size	Power	Voltage	Dimming	Lumens	CCT	Finish	Dimensions	Pre-installed	Certification
CDL7R ROUND										
ASD-CDL7R-6A30-WH	6 inch	12/16/22/26/30 W	120-277V	0-10V	3,461lm	2,700/3,000/3,500/4,000/5,000 K	White	8-1/4" x 8-1/4" x 4-3/8"	-	ETL(5029309), ES, T24, JA8
ASD-CDL7R-8A35WH	8 inch	16/22/26/30/35 W	120-277V	0-10V	4,454lm	2,700/3,000/3,500/4,000/5,000 K	White	10-5/16" x 10-5/16" x 5-5/16"	-	ETL(5029309), ES, T24, JA8
ASD-CDL7R-10A40WH	10 inch	22/26/30/35/40 W	120-277V	0-10V	4,308lm	2,700/3,000/3,500/4,000/5,000 K	White	11-9/16" x 11-9/16" x 5-7/8"	-	ETL(5029309), ES, T24, JA8
CDL7R ROUND WITH BATTERY BACK-UP										
ASD-CDL7R-6A30WH-EM	6 inch	12/16/22/26/30 W	120-277V	0-10V	3,461lm	2,700/3,000/3,500/4,000/5,000 K	White	8-1/4" x 8-1/4" x 4-3/8"	15W Battery Back-up	ETL(5029309)
ASD-CDL7R-8A35WH-EM	8 inch	16/22/26/30/35 W	120-277V	0-10V	4,454lm	2,700/3,000/3,500/4,000/5,000 K	White	10-5/16" x 10-5/16" x 5-5/16"	15W Battery Back-up	ETL(5029309), T24, JA8

For detailed luminous flux information please refer to Annex 1, page 4.

For most up-to-date spec sheets please refer to asd-lighting.com



LED COMMERCIAL DOWNLIGHT

CDL7R series

TECHNICAL PARAMETERS:

Model	Max input current	Inrush current	Work environment	Operating temperature	Power factor	Beam Angle	Surge protection	Housing	Lens	CRI
CDL7R ROUND										
ASD-CDL7R-6A30-WH	0.25A	1A	Wet location	-4°F to 113°F(-20°C to 45°C)	>0,9	88°	2kV	Aluminum	PC	>90
ASD-CDL7R-8A35WH	0.29A	1A	Wet location	-4°F to 113°F(-20°C to 45°C)	>0,9	89°	2kV	Aluminum	PC	>90
ASD-CDL7R-10A40WH	0.34A	1A	Wet location	-4°F to 113°F(-20°C to 45°C)	>0,9	92°	2kV	Aluminum	PC	>90
CDL7R ROUND WITH BATTERY BACK-UP										
ASD-CDL7R-6A30WH-EM	0.25A	1A	Wet location	-4°F to 113°F(-20°C to 45°C)	>0,9	88°	2kV	Aluminum	PC	>90
ASD-CDL7R-8A35WH-EM	0.29A	1A	Wet location	-4°F to 113°F(-20°C to 45°C)	>0,9	89°	2kV	Aluminum	PC	>90

DIMMING COMPATIBLE CONTROLS:

Dimming compatible controls		
Brand	Lutron	Leviton
Models	MS-Z101	IP710-LFZ

PACKAGE CONTENTS:

Description	Quantity
LED Commercial Downlight	1
Wire nut (A)	3
Template for 6, 8 or 10 inch (B)	1
Box	1

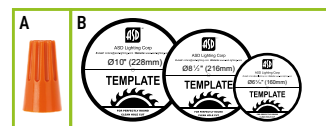

ACCESSORIES (sold separately):

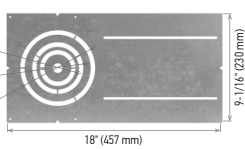
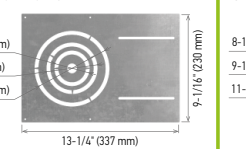
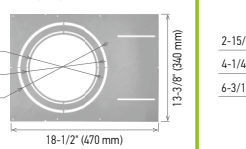
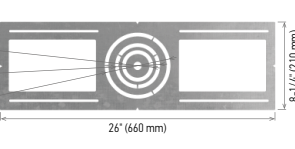
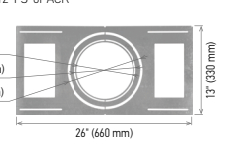
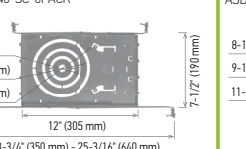
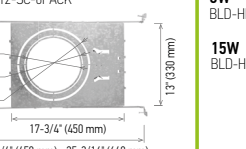
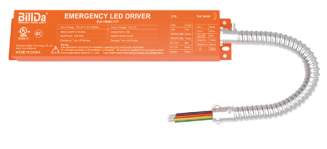
<p>New construction flat mounting plate 18" with asymmetric round holes 3-4-6" ASD-MPLR18-346-FA-6PACK</p>  <p>2-15/16" (75 mm) 4-1/4" (108 mm) 6-3/16" (157 mm) 18" (457 mm) 9-1/16" (230 mm)</p>	<p>New construction flat mounting plate with asymmetric round holes 3-4-6" ASD-MPLR-346-FA-6PACK</p>  <p>2-15/16" (75 mm) 4-1/4" (108 mm) 6-3/16" (157 mm) 13-1/4" (337 mm) 9-1/16" (230 mm)</p>	<p>New construction flat mounting plate with asymmetric round holes 8-10-12" ASD-MPLR-81012-FA-6PACK</p>  <p>8-1/4" (210 mm) 9-1/16" (230 mm) 11-1/4" (285 mm) 18-1/2" (470 mm) 13-3/8" (340 mm)</p>	<p>New construction flat mounting plate with symmetric round holes 3-4-6" ASD-MPLR-346-FS-6PACK</p>  <p>2-15/16" (75 mm) 4-1/4" (108 mm) 6-3/16" (157 mm) 26" (660 mm) 8-1/4" (210 mm)</p>
<p>New construction flat mounting plate with symmetric round holes 8-10-12" ASD-MPLR-81012-FS-6PACK</p>  <p>8-1/4" (210 mm) 9-1/16" (230 mm) 11-1/4" (285 mm) 26" (660 mm) 13" (330 mm)</p>	<p>New construction mounting plate with round holes and sliding clips 3-4-6" ASD-MPLR-346-SC-6PACK</p>  <p>2-7/8" (73 mm) 4-3/16" (106 mm) 6-3/16" (157 mm) 12" (305 mm) 7-1/2" (190 mm) 13-3/4" (350 mm) - 25-3/16" (640 mm)</p>	<p>New construction mounting plate with round holes and sliding clips 8-10-12" ASD-MPLR-81012-SC-6PACK</p>  <p>8-1/4" (210 mm) 9-1/16" (230 mm) 11-1/4" (285 mm) 17-3/4" (450 mm) 13" (330 mm) 17-3/4" (450 mm) - 25-3/16" (640 mm)</p>	<p>Battery back-up kit</p> <p>8W BLD-HM08D</p> <p>15W BLD-HM15D</p> 

ACCESSORY COMPATIBILITY LIST:

Models	Accessories	New construction flat mounting plate with asymmetric round holes 3-4-6"	New construction flat mounting plate 18" with asymmetric round holes 3-4-6"	New construction flat mounting plate with asymmetric round holes 8-10-12"	New construction flat mounting plate with symmetric round holes 3-4-6"	New construction flat mounting plate with symmetric round holes 8-10-12"	New construction mounting plate with round holes and sliding clips 3-4-6"	New construction mounting plate with round holes and sliding clips 8-10-12"	Battery back-up kit 8W	Battery back-up kit 15W
		ASD-MPLR-346-FA-6PACK	ASD-MPLR18-346-FA-6PACK	ASD-MPLR-81012-FA-6PACK	ASD-MPLR-346-FS-6PACK	ASD-MPLR-81012-FS-6PACK	ASD-MPLR-346-SC-6PACK	ASD-MPLR-81012-SC-6PACK	BLD-HM08D	BLD-HM15D
ASD-CDL7R	6"	•	•	•	•	•	•	•	•	•
	8"			•	•	•	•	•	•	•
	10"			•	•	•	•	•	•	•
ASD-CDL7R-EM	6"	•	•	•	•	•	•	•	•	•
	8"			•	•	•	•	•	•	•

For most up-to-date spec sheets please refer to asd-lighting.com



LED COMMERCIAL DOWNLIGHT



CDL7R series

BUILT-IN BACK-UP BATTERY INFORMATION

Model	Battery watts	Lumens in emergency mode	Battery capacity	Emergency mode	Charging time
ASD-CDL7R-6A30WH-EM	15 W	1,719 lm	2600 mAh * 4	> 90 min	≥ 24 hours
ASD-CDL7R-8A35WH-EM	15 W	1,756 lm	2600 mAh * 4	> 90 min	≥ 24 hours

- ▶ Has a self-checking function.
- ▶ AC operation, indicator light will stay on.
- ▶ Emergency operation, indicator light will flash slowly (light on for 2 seconds, lightoff for 2 seconds).
- ▶ In a failure, indicator light will flash quickly (light on for 0.2 seconds, light off for 0.2 seconds).
- ▶ In order to test the Battery back-up, press test switch one time to switch to emergency mode. Press one more time to get back to AC mode.

STANDARD OPERATION DISPLAY STATUS:

Operating condition	 ON
Charging	 ON
Emergency mode	Flash slowly
Test failure	Flash quickly



BATTERY BACK-UP KIT INFORMATION

BLD-HM08D **BLD-HM15D** sold separately:

Specifications	model: BLD-HM08D	model: BLD-HM15D
Input voltage	120-347 Vac, 50/60 Hz	
Input current	≤ 100 mA	
Output voltage	≤ 170 Vdc	≤ 175 Vdc
Output power	8W	15W
Lumen	800 lm	1,000 lm
Application	< 60W (0-10 V dimmable fixture)	< 100W (0/1-10 V dimmable fixture)
Ambient temperature	32°F to 122°F (0°C to 50°C)	

ELECTRICAL SCHEMATIC DIAGRAM:

CDL7 EM kit

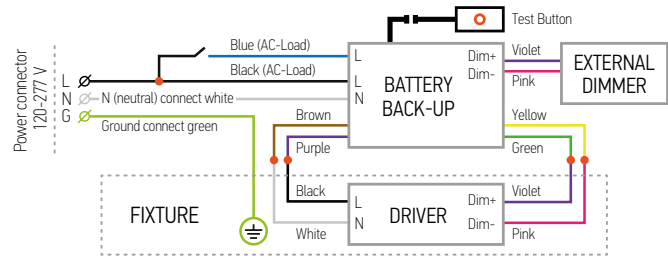

INSTALLATION GUIDE

IMPORTANT SAFETY INFORMATION:

Please read all the instructions below before installation.

- ▶ Make sure that the supply voltage corresponds to the rated product voltage.
- ▶ The product must be installed by a qualified electrician in accordance with the National Electrical Code and corresponding local codes.
- ▶ If the product is damaged, do not use it.

⚠ WARNING

Risk of personal injury – read and follow all warnings and installation instructions. Keep or give to the owner for future reference.

Risk of cuts: Wear gloves to prevent cuts or abrasions when removing from carton, handling, installing, and maintaining this product.

Risk of electric shock: This product must be installed in accordance with the applicable installation code by a person familiar with the construction and operation of the product and the hazards involved.

Risk of Fire: Minimum 194°F supply conductors. Consult a qualified electrician to ensure correct branch circuit conductor.

ASD® assumes no responsibility for claims arising out of improper or careless Installation or handling of this product.

INSTALLATION STEPS:

1. Use template to cut an appropriate sized hole. Before inserting the fixture into the mounting surface opening, choose power and color temperature with a simple switch.
2. Connect the wires using wire nuts: Black to Black, White to White, Green to Green.
3. Fold up the two spring mounting tabs and release as the fixture is placed into the mounting surface. Ensure that the spring mounting tabs have securely mounted the fixture so that the front trim is flush against the mounting surface.



For most up-to-date spec sheets please refer to asd-lighting.com



LED COMMERCIAL DOWNLIGHT

CDL7R series

BATTERY BACK-UP KIT INSTALLATION

BLD-HM08D **BLD-HM15D** sold separately:

1. Secure the battery back-up to the ceiling.
2. Connect wires as shown on electrical diagram.
3. Connect test switch and affix it in the hole on surface.

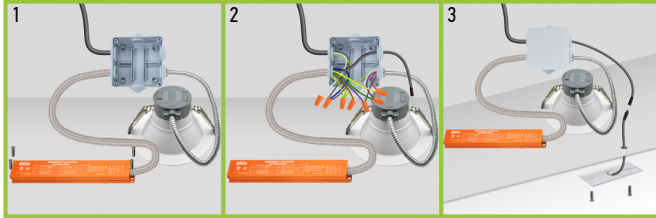

MOUNTING PLATE INSTALLATION

ASD-MPLR-346-FA **ASD-MPLR-81012-FS** **ASD-MPLR18-346-FA**

ASD-MPLR-346-FS **ASD-MPLR-81012-FA** **ASD-MPLR-81012-SC**

ASD-MPLR-346-SC sold separately:

1. Remove the metal ring from the mounting plate according to the size of fixture.
2. Place the mounting plate and secure its position with screws on the beams.

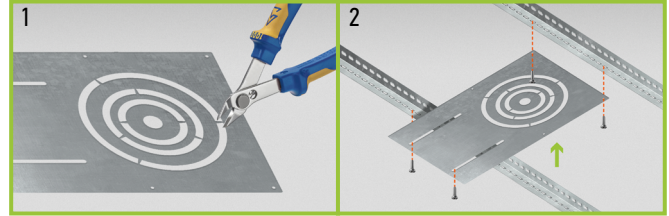

ORDERING INFORMATION

Model	Product dimensions	Weight	Pcs. Per carton	Carton size	Carton weight	UPC	GTIN 14
CDL7R ROUND							
ASD-CDL7R-6A30-WH	8-1/4" x 8-1/4" x 4-3/8"	1.1 lbs(0.5kg)	8	18.82" x 18.58" x 11.89"	13.7 lbs	81012811335	10810128113356
ASD-CDL7R-8A35WH	10-5/16" x 10-5/16" x 5-5/16"	1.4 lbs(0.6kg)	4	22.44" x 11.34" x 9.29"	9.3 lbs	81012811336	10810128113363
ASD-CDL7R-10A40WH	11-9/16" x 11-9/16" x 5-7/8"	1.7 lbs(0.8kg)	4	25.79" x 12.91" x 14.88"	11.2 lbs	81012811337	10810128113370
CDL7R ROUND WITH BATTERY BACK-UP							
ASD-CDL7R-6A30WH-EM	8-1/4" x 8-1/4" x 4-3/8"	2.5 lbs(1.1kg)	8	25.98" x 19.49" x 13.07"	27.3 lbs	81012811439	10810128114391
ASD-CDL7R-8A35WH-EM	10-5/16" x 10-5/16" x 5-5/16"	2.8 lbs(1.3kg)	4	24.33" x 13.07" x 14.65"	16.5 lbs	81012811440	10810128114407

ACCESSORIES:

Model	Description	UPC	Pcs. (pack) per carton	Carton size	Carton weight	GTIN 14 in carton
BLD-HM08D	Battery back-up kit 8W	810128111508	10	17.1" x 14.6" x 11"	19.6 lbs	10810128111505
BLD-HM15D	Battery back-up kit 15W	810050734882	10	17.8" x 13.5" x 9.5"	25.1 lbs	10810050734889
ASD-MPLR-346-FA-6PACK	New construction flat mounting plate with asymmetric round holes 3-4-6"	810050739344	24 (6)	14.4" x 9.8" x 3.2"	18.1 lbs	10810050739341
ASD-MPLR18-346-FA-6PACK	New construction flat mounting plate 18" with asymmetric round holes 3-4-6"	810128112826	24 (6)	18.9" x 9.8" x 3.2"	32.9 lbs	10810128112823
ASD-MPLR-81012-FA-6PACK	New construction flat mounting plate with asymmetric round holes 8-10-12"	810128111553	24 (6)	19.5" x 14.2" x 3.2"	37.2 lbs	10810128111550
ASD-MPLR-346-FS-6PACK	New construction flat mounting plate with symmetric round holes 3-4-6"	810050739351	24 (6)	27" x 9.1" x 3.2"	21 lbs	10810050739358
ASD-MPLR-81012-FS-6PACK	New construction flat mounting plate with symmetric round holes 8-10-12"	810128111577	24 (6)	27" x 13.8" x 3.2"	42.3 lbs	10810128111574
ASD-MPLR-346-SC-6PACK	New construction mounting plate with round holes and sliding clips 3-4-6"	810050739337	12 (6)	17.3" x 11.9" x 13.4"	17 lbs	10810050739334
ASD-MPLR-81012-SC-6PACK	New construction mounting plate with round holes and sliding clips 8-10-12"	810128111607	12 (6)	21.3" x 17.5" x 15.6"	24 lbs	10810128111604

ANNEX 1

Model	Watts	2,700 K	3,000 K	3,500 K	4,000 K	5,000 K
ASD-CDL7R-6A30-WH	12 W	1,332 lm	1,351 lm	1,393 lm	1,423 lm	1,450 lm
	16 W	1,737 lm	1,771 lm	1,832 lm	1,873 lm	1,915 lm
	22 W	2,320 lm	2,377 lm	2,459 lm	2,502 lm	2,527 lm
	26 W	2,641 lm	2,715 lm	2,813 lm	2,861 lm	2,881 lm
	30 W	3,018 lm	3,119 lm	3,242 lm	3,304 lm	3,352 lm
ASD-CDL7R-8A35WH	16 W	1,928 lm	1,953 lm	2,015 lm	2,095 lm	2,613 lm
	22 W	2,569 lm	2,613 lm	2,702 lm	2,757 lm	2,796 lm
	26 W	2,702 lm	2,796 lm	3,048 lm	3,205 lm	3,241 lm
	30 W	3,377 lm	3,452 lm	3,578 lm	3,645 lm	3,681 lm
	35 W	3,838 lm	3,935 lm	4,093 lm	4,178 lm	4,246 lm
ASD-CDL7R-10A40WH	22 W	2,540 lm	2,564 lm	2,585 lm	2,577 lm	2,530 lm
	26 W	3,002 lm	3,038 lm	3,066 lm	3,050 lm	2,984 lm
	30 W	3,384 lm	3,433 lm	3,475 lm	3,459 lm	3,424 lm
	35 W	3,826 lm	3,879 lm	3,932 lm	3,898 lm	3,886 lm
	40 W	4,235 lm	4,316 lm	4,383 lm	4,341 lm	4,308 lm

Model	Watts	2,700 K	3,000 K	3,500 K	4,000 K	5,000 K
ASD-CDL7R-6A30WH-EM	12 W	1,332 lm	1,351 lm	1,393 lm	1,423 lm	1,450 lm
	16 W	1,737 lm	1,771 lm	1,832 lm	1,873 lm	1,915 lm
	22 W	2,320 lm	2,377 lm	2,459 lm	2,502 lm	2,527 lm
	26 W	2,641 lm	2,715 lm	2,813 lm	2,861 lm	2,881 lm
	30 W	3,018 lm	3,119 lm	3,242 lm	3,304 lm	3,352 lm
ASD-CDL7R-8A35WH-EM	16 W	1,928 lm	1,953 lm	2,015 lm	2,095 lm	2,613 lm
	22 W	2,569 lm	2,613 lm	2,702 lm	2,757 lm	2,796 lm
	26 W	2,702 lm	2,796 lm	3,048 lm	3,205 lm	3,241 lm
	30 W	3,377 lm	3,452 lm	3,578 lm	3,645 lm	3,681 lm
	35 W	3,838 lm	3,935 lm	4,093 lm	4,178 lm	4,246 lm

For most up-to-date spec sheets please refer to asd-lighting.com