



# LED SQUARE RECESSED MINI PANEL

► **DESIGN** - LED SQUARE RECESSED MINI PANEL with a classic, low-profile design is an ideal solution for low ceilings. This fixture has a J-box, plug & twist connector, spring-loaded clips, and requires only 2" of ceiling space, making the installation process quick and easy. The acrylic lens with a 110° beam angle and CRI90+ grants you even light. It is designed to operate on 120V circuits, it offers smooth dimming capabilities from 10% to 100%.

► **VARIETY** - This fixture is available in square shape with sizes of 3", 4", 6" and 8". Choose from White, Nickel, Bronze or Black finishes. Square models in 4" and 6" sizes are offered with both square and round bases.

► **COLOR SELECTABLE** - You can choose either a 2700K soft white, 3000K warm white, 3500K neutral white, 4000K cool white, or 5000K daylight color temperature.

► **INSTALLATION** - This fixture is IC rated so there is no can or any other housing required. It is also Wet Locations rated, making it perfect for kitchen, bathroom or any other common areas.

► **ADVANTAGES** - With a lifespan of 54,000 hours, these fixtures are made to last decades under normal operation! ASD provides a 5-year limited warranty along with UL certifications to guarantee top quality products and safety!

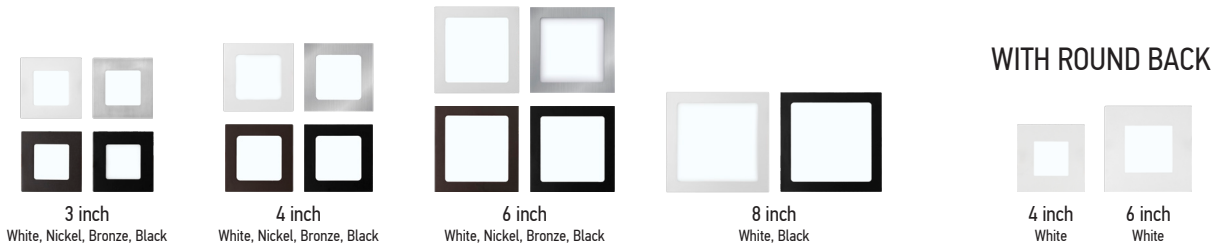
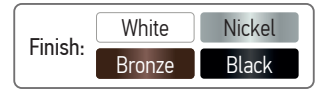

## PRODUCT PRESENTATION:

Model	Size	Power	Voltage	Dimming	Lumens	CCT	Finish	Dimensions	Certification
<b>JBS-AC SQUARE</b>									
ASD-JBS-3D6AC-WH-6PACK	3 inch	6 W	120V	Triac	456lm	2,700/3,000/3,500/4,000/5,000K	White	3-1/4" x 3-1/4" x 9/16"	UL(E473854)
ASD-JBS-3D6AC-NK-6PACK	3 inch	6 W	120V	Triac	456lm	2,700/3,000/3,500/4,000/5,000K	Nickel	3-1/4" x 3-1/4" x 9/16"	UL(E473854)
ASD-JBS-3D6AC-BZ-6PACK	3 inch	6 W	120V	Triac	456lm	2,700/3,000/3,500/4,000/5,000K	Bronze	3-1/4" x 3-1/4" x 9/16"	UL(E473854)
ASD-JBS-3D6AC-BK-6PACK	3 inch	6 W	120V	Triac	456lm	2,700/3,000/3,500/4,000/5,000K	Black	3-1/4" x 3-1/4" x 9/16"	UL(E473854)
ASD-JBS-4D12AC-WH-6PACK	4 inch	12 W	120V	Triac	784lm	2,700/3,000/3,500/4,000/5,000K	White	4-5/8" x 4-5/8" x 9/16"	UL(E473854)
ASD-JBS-4D12AC-NK-6PACK	4 inch	12 W	120V	Triac	784lm	2,700/3,000/3,500/4,000/5,000K	Nickel	4-5/8" x 4-5/8" x 9/16"	UL(E473854)
ASD-JBS-4D12AC-BZ-6PACK	4 inch	12 W	120V	Triac	784lm	2,700/3,000/3,500/4,000/5,000K	Bronze	4-5/8" x 4-5/8" x 9/16"	UL(E473854)
ASD-JBS-4D12AC-BK-6PACK	4 inch	12 W	120V	Triac	784lm	2,700/3,000/3,500/4,000/5,000K	Black	4-5/8" x 4-5/8" x 9/16"	UL(E473854)
ASD-JBS-6D15AC-WH-6PACK	6 inch	15 W	120V	Triac	1,197lm	2,700/3,000/3,500/4,000/5,000K	White	6-9/16" x 6-9/16" x 9/16"	UL(E473854)
ASD-JBS-6D15AC-NK-6PACK	6 inch	15 W	120V	Triac	1,197lm	2,700/3,000/3,500/4,000/5,000K	Nickel	6-9/16" x 6-9/16" x 9/16"	UL(E473854)
ASD-JBS-6D15AC-BZ-6PACK	6 inch	15 W	120V	Triac	1,197lm	2,700/3,000/3,500/4,000/5,000K	Bronze	6-9/16" x 6-9/16" x 9/16"	UL(E473854)
ASD-JBS-6D15AC-BK-6PACK	6 inch	15 W	120V	Triac	1,197lm	2,700/3,000/3,500/4,000/5,000K	Black	6-9/16" x 6-9/16" x 9/16"	UL(E473854)
ASD-JBS-8D20AC-WH	8 inch	20 W	120V	Triac	1,743lm	2,700/3,000/3,500/4,000/5,000K	White	8-11/16" x 8-11/16" x 9/16"	UL(E473854)
ASD-JBS-8D20AC-BK	8 inch	20 W	120V	Triac	1,743lm	2,700/3,000/3,500/4,000/5,000K	Black	8-11/16" x 8-11/16" x 9/16"	UL(E473854)
<b>JBSR-AC SQUARE WITH ROUND BACK</b>									
ASD-JBSR-4D12AC-WH	4 inch	12 W	120V	Triac	872lm	2,700/3,000/3,500/4,000/5,000K	White	5-1/8" x 5-1/8" x 1"	UL(E473854)
ASD-JBSR-6D15AC-WH	6 inch	15 W	120V	Triac	1,266lm	2,700/3,000/3,500/4,000/5,000K	White	7-3/16" x 7-3/16" x 1"	UL(E473854)

For most up-to-date spec sheets please refer to [asd-lighting.com](http://asd-lighting.com)





# LED SQUARE RECESSED MINI PANEL

## TECHNICAL PARAMETERS:

Model	Work environment	Operating temperature	Power factor	Surge protection	Housing	Lens	CRI	Beam Angle
<b>JBS-AC SQUARE</b>								
ASD-JBS-3D6AC-WH-6PACK	Wet location	-4°F to 104°F (-20°C to 40°C)	>0,9	2kV	Aluminum	PC	>90	110°
ASD-JBS-3D6AC-NK-6PACK	Wet location	-4°F to 104°F (-20°C to 40°C)	>0,9	2kV	Aluminum	PC	>90	110°
ASD-JBS-3D6AC-BZ-6PACK	Wet location	-4°F to 104°F (-20°C to 40°C)	>0,9	2kV	Aluminum	PC	>90	110°
ASD-JBS-3D6AC-BK-6PACK	Wet location	-4°F to 104°F (-20°C to 40°C)	>0,9	2kV	Aluminum	PC	>90	110°
ASD-JBS-4D12AC-WH-6PACK	Wet location	-4°F to 104°F (-20°C to 40°C)	>0,9	2kV	Aluminum	PC	>90	110°
ASD-JBS-4D12AC-NK-6PACK	Wet location	-4°F to 104°F (-20°C to 40°C)	>0,9	2kV	Aluminum	PC	>90	110°
ASD-JBS-4D12AC-BZ-6PACK	Wet location	-4°F to 104°F (-20°C to 40°C)	>0,9	2kV	Aluminum	PC	>90	110°
ASD-JBS-4D12AC-BK-6PACK	Wet location	-4°F to 104°F (-20°C to 40°C)	>0,9	2kV	Aluminum	PC	>90	110°
ASD-JBS-6D15AC-WH-6PACK	Wet location	-4°F to 104°F (-20°C to 40°C)	>0,9	2kV	Aluminum	PC	>90	110°
ASD-JBS-6D15AC-NK-6PACK	Wet location	-4°F to 104°F (-20°C to 40°C)	>0,9	2kV	Aluminum	PC	>90	110°
ASD-JBS-6D15AC-BZ-6PACK	Wet location	-4°F to 104°F (-20°C to 40°C)	>0,9	2kV	Aluminum	PC	>90	110°
ASD-JBS-6D15AC-BK-6PACK	Wet location	-4°F to 104°F (-20°C to 40°C)	>0,9	2kV	Aluminum	PC	>90	110°
ASD-JBS-8D20AC-WH	Wet location	-4°F to 104°F (-20°C to 40°C)	>0,9	2kV	Aluminum	PC	>90	110°
ASD-JBS-8D20AC-BK	Wet location	-4°F to 104°F (-20°C to 40°C)	>0,9	2kV	Aluminum	PC	>90	110°
<b>JBSR-AC SQUARE WITH ROUND BACK</b>								
ASD-JBSR-4D12AC-WH	Wet location	-4°F to 104°F (-20°C to 40°C)	>0,9	2kV	Aluminum	PC	>90	110°
ASD-JBSR-6D15AC-WH	Wet location	-4°F to 104°F (-20°C to 40°C)	>0,9	2kV	Aluminum	PC	>90	110°

## LED SQUARE RECESSED MINI PANEL BACK

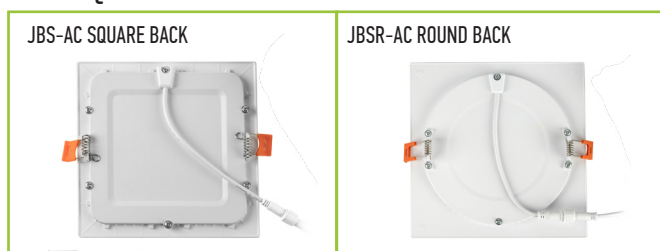

## DIMMING COMPATIBLE CONTROLS:

Brand	Lutron	Leviton	
Models	CTCL-153PDH-WH	S-600PR-WH	DB33K1
	DVW-603PGH-WH	CTCL-153P	1A2305
	MIR-600THW-WH	DV-600P	1F4205
	MACL-153M-WH	NT-1000	6633-P
	CT-603PGH-WH	S-603P	VP106
	DVCL-163P-WH	S-600P	IPL06
	SLV-600P-WH	4X603	6683
			6674
			6672

## PACKAGE CONTENTS:

Description	Quantity
LED Square Recessed Mini Panel	1 (6 for 6 pack)
Template for 3, 4, 6, 8 or inch (A)	1
Box	1

## DIMENSIONS JUNCTION BOX:

Fixture	Junction box
3 inch	3-3/4" x 2-5/16" x 1-1/4" (95mm x 59mm x 32mm)
4, 6, 8 inch	4-8/16" x 2-11/16" x 1-3/8" (115mm x 68mm x 35mm)

## TEMPLATE SIZE:

Model	Fixture	Template size
ASD-JBS-AC	3 inch	2-7/8 x 2-7/8" (73 x 73mm)
	4 inch	4-15/16 x 4-15/16" (110 x 110mm)
	6 inch	6-1/8 x 6-1/8" (155 x 155mm)
	8 inch	8-1/4 x 8-1/4" (210 x 210mm)
ASD-JBSR-AC WITH ROUND BACK	4 inch	4-5/16" (110 mm)
	6 inch	6-5/16" (160 mm)

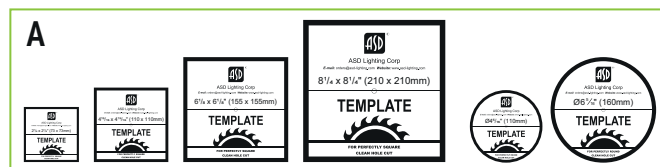





For most up-to-date spec sheets please refer to [asd-lighting.com](http://asd-lighting.com)

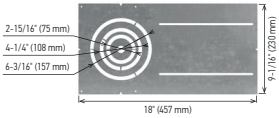
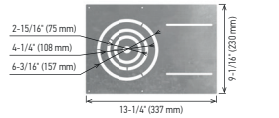
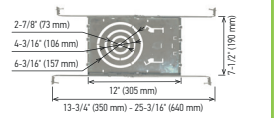
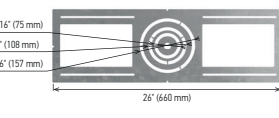
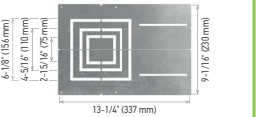
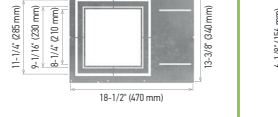
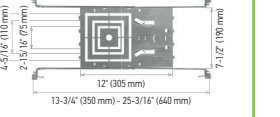
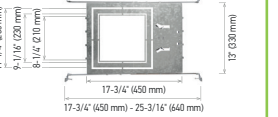

# LED SQUARE RECESSED MINI PANEL

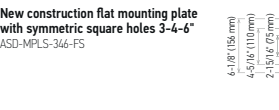
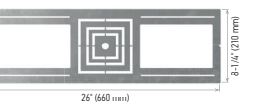
## ACCESSORIES (sold separately):

<b>New construction flat mounting plate with asymmetric round holes 3-4-6"</b> ASD-MPLR18-346-FA 	<b>New construction flat mounting plate with asymmetric round holes 3-4-6"</b> ASD-MPLR-346-FA 	<b>New construction mounting plate with square holes and sliding clips 3-4-6"</b> ASD-MPLR-346-SC 	<b>New construction flat mounting plate with symmetric round holes 3-4-6"</b> ASD-MPLR-346-FS 	
<b>New construction flat mounting plate with asymmetric square holes 3-4-6"</b> ASD-MPLS-346-FA 	<b>New construction flat mounting plate with asymmetric square holes 8-10-12"</b> ASD-MPLS-81012-FA 	<b>New construction mounting plate with square holes and sliding clips 3-4-6"</b> ASD-MPLS-346-SC 	<b>New construction mounting plate with square holes and sliding clips 8-10-12"</b> ASD-MPLS-81012-SC 	<b>Extension cord 3PIN</b> 
<b>New construction flat mounting plate with symmetric square holes 3-4-6"</b> ASD-MPLS-346-FS 	<b>New construction flat mounting plate with symmetric square holes 8-10-12"</b> ASD-MPLS-81012-FS 	<b>New construction flat mounting plate with symmetric square holes 8-10-12"</b> ASD-MPLS-81012-FS 	<b>10"</b> ASD-EC-10A <b>20"</b> ASD-EC-20A 	

## ACCESSORY COMPATIBILITY LIST FOR JBS:

Accessories	Model	New construction flat mounting plate with asymmetric square holes 3-4-6"	New construction flat mounting plate with asymmetric square holes 8-10-12"	New construction flat mounting plate with symmetric square holes 3-4-6"	New construction flat mounting plate with symmetric square holes 8-10-12"	New construction mounting plate with square holes and sliding clips 3-4-6"	New construction mounting plate with square holes and sliding clips 8-10-12"	Extension cord 3PIN
ASD-JBS AC	3"	•	•	•	•	•	•	•
	4"	•	•	•	•	•	•	•
	6"	•	•	•	•	•	•	•
	8"	•	•	•	•	•	•	•

## ACCESSORY COMPATIBILITY LIST FOR JBSR:

Accessories	Model	New construction flat mounting plate with asymmetric round holes 3-4-6"	New construction flat mounting plate with asymmetric round holes 3-4-6"	New construction flat mounting plate with symmetric round holes 3-4-6"	New construction mounting plate with round holes and sliding clips 3-4-6"	Extension cord 3PIN
ASD-JBSR AC	4"	•	•	•	•	•
	6"	•	•	•	•	•
	8"	•	•	•	•	•

# INSTALLATION GUIDE

## IMPORTANT SAFETY INFORMATION:

Please read all the instructions below before installation.

- ▶ Make sure that the supply voltage corresponds to the rated product voltage.
- ▶ The product must be installed by a qualified electrician in accordance with the National Electrical Code and corresponding local codes.
- ▶ If the product is damaged, do not use it.

## ⚠ WARNING

**Risk of personal injury** – read and follow all warnings and installation instructions. Keep or give to the owner for future reference.

**Risk of cuts:** Wear gloves to prevent cuts or abrasions when removing from carton, handling, installing, and maintaining this product.

**Risk of electric shock:** This product must be installed in accordance with the applicable installation code by a person familiar with the construction and operation of the product and the hazards involved.

**Risk of Fire:** Minimum 194°F supply conductors. Consult a qualified electrician to ensure correct branch circuit conductor.

ASD® assumes no responsibility for claims arising out of improper or careless installation or handling of this product.

## INSTALLATION STEPS:

1. Use template to cut an appropriate sized hole. Disconnect the fixture from the junction box. Choose needed color temperature by adjusting the switch. Close the junction box.
2. Open junction box. Connect the wires: Black to Black, White to White, Copper to Green. Secure the connection with quick connector.
3. Insert the junction box into the cut hole, leaving the connection cable outside. Connect the fixture to the Junction box inserting the cable and securing it with a cap. Push the spring loaded clips upwards and insert the fixture base into the mounting hole. Release the clips, so the fixture fits securely.

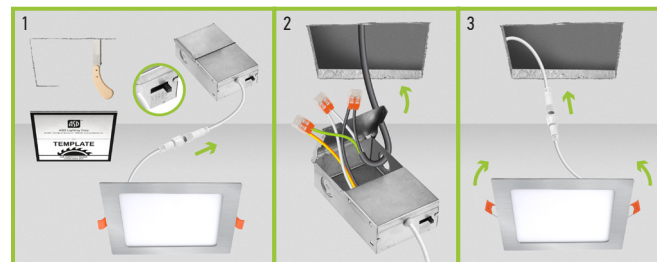

\* The fixture is suitable for ceiling thickness less than 0.5 inch.

For most up-to-date spec sheets please refer to [asd-lighting.com](http://asd-lighting.com)



# LED SQUARE RECESSED MINI PANEL

## MOUNTING PLATE INSTALLATION:

- ASD-MPLR-346-FA   ASD-MPLR18-346-FA   ASD-MPLR-346-FS
- ASD-MPLR-346-SC   ASD-MPLS-346-FA   ASD-MPLS-81012-FA
- ASD-MPLS-346-FS   ASD-MPLS-81012-FS   ASD-MPLS-346-SC
- ASD-MPLS-81012-SC   **sold separately**

1. Remove the metal ring from the mounting plate according to the size of fixture.
2. Place the mounting plate and secure its position with screws on the beams.

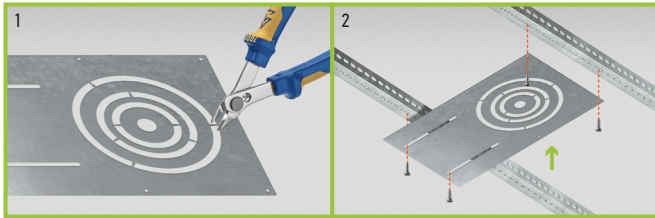

## EXTENSION CORD INSTALLATION:

- ASD-EC-10A   ASD-EC-20A   **sold separately**

1. Disconnect the LED Mini Panel cable from the Junction box cable.
2. Connect one end of the Extension Cord to the LED Mini Panel cable, and the other end of the Extension Cord to the Junction box cable.



## ORDERING INFORMATION

Model	Product dimensions	Weight	Pcs. Per carton	Carton size	Carton weight	UPC	GTIN 14
<b>JBS-AC SQUARE</b>							
ASD-JBS-3D6AC-WH-6PACK	3-1/4" x 3-1/4" x 9/16"	2.6 lbs(1.2kg)	2	17.13" x 10.04" x 4.53"	6.6 lbs	81005073752	10810050737521
ASD-JBS-3D6AC-NK-6PACK	3-1/4" x 3-1/4" x 9/16"	2.6 lbs(1.2kg)	2	17.13" x 10.04" x 4.53"	6.6 lbs	81005073841	20810050738419
ASD-JBS-3D6AC-BZ-6PACK	3-1/4" x 3-1/4" x 9/16"	2.6 lbs(1.2kg)	2	17.13" x 10.04" x 4.53"	6.6 lbs	81920102246	20819201022469
ASD-JBS-3D6AC-BK-6PACK	3-1/4" x 3-1/4" x 9/16"	2.6 lbs(1.2kg)	2	17.13" x 10.04" x 4.53"	6.6 lbs	81005073754	10810050737545
ASD-JBS-4D12AC-WH-6PACK	4-5/8" x 4-5/8" x 9/16"	3.7 lbs(1.7kg)	2	12.60" x 12.60" x 6.30"	9.3 lbs	81005073728	10810050737286
ASD-JBS-4D12AC-NK-6PACK	4-5/8" x 4-5/8" x 9/16"	3.7 lbs(1.7kg)	2	12.60" x 12.60" x 6.30"	9.3 lbs	81005073842	20810050738426
ASD-JBS-4D12AC-BZ-6PACK	4-5/8" x 4-5/8" x 9/16"	3.7 lbs(1.7kg)	2	12.60" x 12.60" x 6.30"	9.3 lbs	81005073892	10810050738924
ASD-JBS-4D12AC-BK-6PACK	4-5/8" x 4-5/8" x 9/16"	3.7 lbs(1.7kg)	2	12.60" x 12.60" x 6.30"	9.3 lbs	81005073730	10810050737309
ASD-JBS-6D15AC-WH-6PACK	6-9/16" x 6-9/16" x 9/16"	5.0 lbs(2.3kg)	2	13.98" x 12.40" x 7.99"	12.1 lbs	81005073732	10810050737323
ASD-JBS-6D15AC-NK-6PACK	6-9/16" x 6-9/16" x 9/16"	5.0 lbs(2.3kg)	2	13.98" x 12.40" x 7.99"	12.1 lbs	81005073843	20810050738433
ASD-JBS-6D15AC-BZ-6PACK	6-9/16" x 6-9/16" x 9/16"	5.0 lbs(2.3kg)	2	13.98" x 12.40" x 7.99"	12.1 lbs	81005073893	10810050738931
ASD-JBS-6D15AC-BK-6PACK	6-9/16" x 6-9/16" x 9/16"	5.0 lbs(2.3kg)	2	13.98" x 12.40" x 7.99"	12.1 lbs	81005073756	10810050737569
ASD-JBS-8D20AC-WH	8-11/16" x 8-11/16" x 9/16"	1.1 lbs(0.5kg)	4	10.43" x 9.65" x 9.45"	6.6 lbs	81005073757	10810050737576
ASD-JBS-8D20AC-BK	8-11/16" x 8-11/16" x 9/16"	1.1 lbs(0.5kg)	4	10.43" x 9.65" x 9.45"	6.6 lbs	81005073758	10810050737583
<b>JBSR-AC SQUARE WITH ROUND BACK</b>							
ASD-JBSR-4D12AC-WH	5-1/8" x 5-1/8" x 1"	0.7 lbs(0.3kg)	6	12.40" x 10.63" x 5.91"	5.5 lbs	81012811805	10810128118054
ASD-JBSR-6D15AC-WH	7-3/16" x 7-3/16" x 1"	0.9 lbs(0.4kg)	6	16.34" x 10.43" x 8.07"	7.3 lbs	81012811806	10810128118061

## ACCESSORIES:

Model	Product dimensions	Pcs. (pack) per carton	Carton size	Carton weight	UPC	GTIN 14
ASD-MPLR-346-FA-6PACK	13-1/4" x 9-1/16" x 1/16"	24 (4)	14.4" x 9.8" x 3.2"	18.1 lbs	810050739344	10810050739341
ASD-MPLR18-346-FA-6PACK	18" x 9-1/16" x 1/16"	24 (4)	18.9" x 9.8" x 3.2"	32.9 lbs	810128112826	10810128112823
ASD-MPLR-346-FS-6PACK	26" x 8-1/4" x 1/16"	24 (4)	27" x 9.1" x 3.2"	21 lbs	810050739351	10810050739358
ASD-MPLR-346-SC-6PACK	14-3/8" x 10-9/16" x 1-5/8"	12 (2)	17.3" x 11.9" x 13.4"	17 lbs	810050739337	10810050739334
ASD-MPLS-346-FA-6PACK	13-1/4" x 9-1/16" x 1/16"	24 (4)	14.4" x 9.8" x 3.2"	17.7 lbs	810128110303	10810128110300
ASD-MPLS-81012-FA-6PACK	18-1/2" x 13-3/8" x 1/16"	24 (4)	19.5" x 14.2" x 3.2"	36.3 lbs	810128112833	10810128112830
ASD-MPLS-346-FS-6PACK	26" x 8-1/4" x 1/16"	24 (4)	27" x 9.1" x 3.2"	20.7 lbs	810128110310	10810128110317
ASD-MPLS-81012-FS-6PACK	26" x 13" x 1/16"	24 (4)	27" x 13.8" x 3.2"	40.7 lbs	810128112840	10810128112847
ASD-MPLS-346-SC-6PACK	14-3/8" x 10-9/16" x 1-5/8"	12 (2)	17.3" x 11.9" x 13.4"	16.5 lbs	810128110327	10810128110324
ASD-MPLS-81012-SC-6PACK	17-11/16" x 13" x 1-9/16"	12 (2)	21.3" x 17.5" x 15.6"	24 lbs	810128118040	10810128118047
ASD-EC-10A-6PACK	-	60 (10)	7.7" x 6.1" x 5.3"	1.8 lbs	810128110471	10810128110478
ASD-EC-20A-6PACK	-	60 (10)	7.7" x 6.1" x 5.3"	3.1 lbs	810128110488	10810128110485

For most up-to-date spec sheets please refer to [asd-lighting.com](http://asd-lighting.com)